

INVENTORY FORM B CONTINUATION SHEET

GEORGETOWN

67 North Street

MASSACHUSETTS HISTORICAL COMMISSION

Area(s) Form No.

GEO.263

220 MORRISSEY BOULEVARD, BOSTON, MASSACHUSETTS 02125

FORM B – BUILDING

MASSACHUSETTS HISTORICAL COMMISSION
MASSACHUSETTS ARCHIVES BUILDING
220 MORRISSEY BOULEVARD
BOSTON, MASSACHUSETTS 02125

Photograph



View from SW.

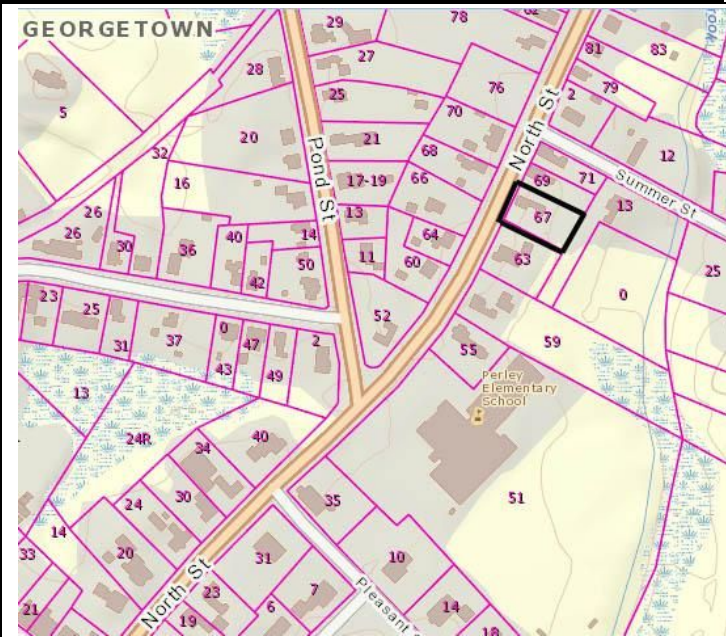

Source: Mass GIS Oliver Parcel Viewer

Recorded by: Kathryn Grover & Neil Larson
Organization: Town of Georgetown Historical Commission
Date: June 2017

Locus Map (north at top)

INVENTORY FORM B CONTINUATION SHEET

GEORGETOWN

67 North Street

MASSACHUSETTS HISTORICAL COMMISSION

Area(s) Form No.

GEO.263

220 MORRISSEY BOULEVARD, BOSTON, MASSACHUSETTS 02125

Assessor's Number USGS Quad Area(s) Form Number

Setting: Part of a densely developed streetscape of single-family houses within the village center.

11A-129

Georgetown

GEO.263

Town/City: Georgetown

Place: (*neighborhood or village*):
Georgetown Center

Address: 67 North Street

Historic Name: Ilsley-Watson House

Uses: Present: single family residential
Original: single family residential

Date of Construction: ca. 1860

Source: deeds & visual assessment

Style/Form: Gothic Revival

Architect/Builder: unknown

Exterior Material:

Foundation: brick

Wall/Trim: vinyl clapboards

Roof: asphalt shingles

Outbuildings/Secondary Structures:
Barn (connected)

Major Alterations (*with dates*):

Entrance porch & dormers added, 20th century
Vinyl siding added
Window sash replaced

Condition: fair

Moved: no ☒ yes ☐ **Date:**

Acreage: 0.3 acre

INVENTORY FORM B CONTINUATION SHEET

GEORGETOWN

67 North Street

MASSACHUSETTS HISTORICAL COMMISSION

Area(s) Form No.

GEO.263

220 MORRISSEY BOULEVARD, BOSTON, MASSACHUSETTS 02125

☒ Recommended for listing in the National Register of Historic Places.

If checked, you must attach a completed National Register Criteria Statement form.

ARCHITECTURAL DESCRIPTION:

The Isley-Watson House is a story-and-a-half wood frame single dwelling with a gable roof built about 1860. In plan and design it is an end house with its entrance off center on the street-facing three-bay gable end. The entrance is now contained in a later gable roof porch; two windows are evenly spaced in the upper half story and a half-round vent is centered in the apex of the gable. Scroll-sawn verge boards decorate the roof edge, but they may be later additions. The southerly side contains four windows, two each for two rooms aligned front to back; a chimney is located in the partition wall between them. Two broken-eave dormers were added to the roof at a later time. The northerly side is windowless except for a lone window in the rear for the room behind the stairs, which run up the blank front section of the wall. A one-story service wing extends from the rear of the house and connects to a small domestic barn with a cross-gable roof and a shed-roof wing. Fenestration has been altered removing wagon and mow doors and associated windows.

The building is situated tight along the northerly side of the lot with a minimal front yard separating it from the street. A parking area has been paved on the southerly side of the frontage and a large yard occupies the rear.

HISTORICAL NARRATIVE

In April 1846, Nathaniel Nelson sold a lot of 100 by 50 feet on North Street to Harriet Isley. In September 1850 Georgetown physician Moses Atwood sold her another lot of land, described as being on the east side of North Street and south of his own land.¹ The house numbered 67 North Street was built between 1856 and 1860 on one or the other of these two lots.

Harriet Goodridge Isley, from West Newbury, was the widow of William Isley (ca 1790-1849), part of a family with deep roots in Newbury. William, probably the son of Jonathan and Mary Adams Isley, had moved to Stratham, New Hampshire, by 1825; son Jonathan Adams Isley was born there in 1825. William Isley died in Stratham in 1849, and by 1850 his widow Harriet was living in Georgetown with her son Jonathan, who worked as a blacksmith. In 1855 Harriet and Jonathan were again living in a household together; in his sister Eunice, who had married True G. Morrill in Georgetown in 1849 lived nearby. By 1860 Jonathan A. Isley had married Mary Louise Sophia Searle, daughter of Stephen and Sarah Spofford Searle, also near neighbors. Though the house at 67 North Street does not appear on the 1856 map of Georgetown Center, it was probably built between that year and 1860, when the census shows Jonathan and M. Sophia Isley with \$1000 in real property, living in this neighborhood with Jonathan's mother Harriet, then a 69-year-old shoe binder, and 11-year-old William H. Isley, the son of Jonathan's aunt Susan, who had married Joseph Lombard in Georgetown in 146 and had died soon after her son was born. According to a Goodridge family genealogy, William was raised by his grandmother Harriet Goodridge Isley and took the name William Henry Isley.²

The 1870 census shows Harriet Isley with \$900 in real property living still with her son Jonathan, shown with \$300 in real property, his wife Mary Sophia, and their children Mary Sophia, born in 1860; Joseph Jeremiah, born in 1862, and Mary Eunice, born in 1870. The 1872 Georgetown map attaches the name "Mrs. Isley" to the house at 67 North Street. In 1877 Harriet Goodridge Isley died, and probate records document that she owned a house, barn, and land valued at \$1000 and \$160.36 in personal property. She had left her daughter Ann Isley Dunham the use of the front room and front bedroom in the North Street house and right to pass to the cellar, well, and barn for her lifetime, as well as her bedding, clothing, and any cash left after her debts were paid. She left sons Moses (then living in Des Moines, Iowa) and Joseph (living in Anderson, Indiana) one dollar each and son Jonathan Adams Isley the rest of her real and personal estate. The 1880 census shows Isley in this neighborhood as

¹ Nathaniel Nelson to Harriet Isley, 30 April 1846, SECD 366:286; Moses Atwood to Harriet Isley, 20 September 1850, SECD 434:51 & 52. This second deed identifies the southern boundary as the land of Joseph Hilliard, who is shown south of this property on the 1872 Georgetown center map.

² Edwin Alonzo Goodridge, *A Goodridge Genealogy: A History of the Descendants of William Goodridge* (New York: privately printed, 1918), 183.

INVENTORY FORM B CONTINUATION SHEET

GEORGETOWN

67 North Street

MASSACHUSETTS HISTORICAL COMMISSION

Area(s) Form No.

GEO.263

220 MORRISSEY BOULEVARD, BOSTON, MASSACHUSETTS 02125

J. Adams Ilsley in a household with his wife and children Joseph, Mary Eunice, and William Adams, born in 1878; daughter Sarah Sophia was living across the street in the home of her grandfather, Stephen Searle.

In 1880, J. Adams Ilsley sold his mother's 67 North Street home to his father-in-law, Stephen Searle, and a month later Searle transferred title to the property to his daughter Mary Louise Sophia Ilsley. J. Adams Ilsley died in 1890, and in 1900 his widow married widower George S. Weston of Georgetown. She continued to own 67 North Street until her death in January 1917. The administrator of her estate sold the property to Thomas A. Watson in August of the same year, whose family owned it until 1950.³

Born in Haverhill in 1885, Thomas Adlington Watson was the son of English immigrants and worked in his early life as a mason. In 1911 he married Georgetown milliner Mildred H. Thwing, daughter of Arthur C. and Hattie G. Hardy Thwing, and the couple boarded at 34 North Street in 1916. By then Thomas Watson had opened a confectionary and ice cream store at 11 West Main Street, and he was in that business and living at 67 North Street when he registered for the military draft in 1918. The 1920 census shows him as a restaurant proprietor living in the house with his wife; in 1930 he is shown as chef in his own restaurant, and Mildred worked there as a waitress. The 1940 directory shows him as proprietor of Watson's Lunch at 17 West Main Street.

In 1950 Mildred Watson sold 67 North Street to Norman A. Trumbull, and in 1959 it became the property of Martin F. Curran, who owned and occupied it with his wife Patricia for the rest of their lives. In 2009, after Patricia Curran's death, her estate executor sold the property to Joseph R. and Heather H. Seddelmeyer, who in turn sold it in 2016 to current owners Rebecca M. Anderson and Cathy A. Tranfaglia.⁴

BIBLIOGRAPHY and/or REFERENCES

AmericanAncestors.org.

Ancestry.com.

Assessor's Records, Georgetown and Rowley. 1883, 1902, 1920, 1933.

Bureau of the Census. United States Census, 1790-1930.

Nelson, Henry M. "Town of Georgetown History." In Hurd, D. Hamilton. *History of Essex County, Massachusetts, with Biographical Sketches of Many of Its Pioneers and Prominent Men*. Vol. 1. Philadelphia: J. W. Lewis and Co., 1888.

Southern Essex County Registry of Deeds website, salemdeeds.com.

DIRECTORIES

Georgetown, Boxford, Byfield, Newbury, and West Newbury, Massachusetts, Directory. Boston: W. E. Shaw, 1901-2, 1905.

North Essex Directory for Boxford, Georgetown, Merrimac, Newbury, Rowley, Salisbury, West Newbury. Salem, MA: Henry M. Meek Publishing Co., 1907, 1909-10, 1912, 1914-15, 1916-17, 1918, 1925.

Ipswich, Boxford, Byfield, Georgetown, Newbury, Rowley, Salisbury, Salisbury Beach, Topsfield, West Newbury Directory. Vol. 1, 1932-'34. Beverly, MA, and Portland, ME: Crowley & Lunt, 1932.

Haverhill, Mass. Suburban Directory for Georgetown, Groveland, Merrimac and West Newbury 1940. North Hampton, NH: Crosby Publishing Co., 1940.

Ipswich, Boxford, Georgetown, Middleton, Newbury, Rowley, Salisbury, Topsfield, West Newbury Directory 1957. New Haven, CT: Price & Lee Co., 1957.

MAPS

³ J. Adams Ilsley to Stephen Searle, 17 May 1880, SECD 1037:129; Stephen Searle to Mary Louise Sophia Ilsley, 16 June 1880, SECD 1055:192; Robert F. Metcalf, administrator estate Sophia S. Weston aka Mary Louisa Sophia Weston, to Thomas A. Watson, 14 August 1917, SECD 2373:121.

⁴ Mildred H. Watson to Norman A. Trumbull, 20 January 1950, SECD 3717:349; Richard P. and Maria M. Merrill to Martin F. Curran, 15 May 1959, SECD 4561:263; Alicia Hammond, Sutton MA, executor estate Patricia M. Curran, to Joseph R. and Heather H. Seddelmeyer, 12 November 2009, SECD 29070:37; Joseph R. and Heather H. Seddelmeyer to Rebecca M. Anderson and Cathy A. Tranfaglia, 25 August 2016, SECD 35216:534.

INVENTORY FORM B CONTINUATION SHEET

GEORGETOWN

67 North Street

MASSACHUSETTS HISTORICAL COMMISSION

Area(s) Form No.

GEO.263

220 MORRISSEY BOULEVARD, BOSTON, MASSACHUSETTS 02125

Map of Georgetown. 1856. In Walling. H. F. *A Topographical Map Essex County Massachusetts*. Boston: Smith and Morley, 1856.

Atlas of Essex County, Massachusetts. Philadelphia: D. G. Beers and Co., 1872). Plates 59 and 61.

“Town of Georgetown Mass.” and “Village of Georgetown Mass.” In *Atlas of Essex County, Massachusetts* (Boston: George H. Walker, 1884).

“Georgetown, Mass. 1887.” Drawn and Published by George E. Norris, Brockton, Massachusetts. Troy, NY: Burleigh Lithographic Establishment, 1887.”

INVENTORY FORM B CONTINUATION SHEET

GEORGETOWN

67 North Street

MASSACHUSETTS HISTORICAL COMMISSION

Area(s) Form No.

GEO.263

220 MORRISSEY BOULEVARD, BOSTON, MASSACHUSETTS 02125

PHOTOGRAPHS (all photos by Neil Larson, 2017)



View from SE.

INVENTORY FORM B CONTINUATION SHEET

GEORGETOWN

67 North Street

MASSACHUSETTS HISTORICAL COMMISSION

Area(s) Form No.

GEO.263

220 MORRISSEY BOULEVARD, BOSTON, MASSACHUSETTS 02125



View from NE.

INVENTORY FORM B CONTINUATION SHEET

GEORGETOWN

67 North Street

MASSACHUSETTS HISTORICAL COMMISSION

Area(s) Form No.

GEO.263

220 MORRISSEY BOULEVARD, BOSTON, MASSACHUSETTS 02125



Aerial view from south. Source: [bing.com/maps](https://www.bing.com/maps).

INVENTORY FORM B CONTINUATION SHEET

GEORGETOWN

67 North Street

MASSACHUSETTS HISTORICAL COMMISSION

Area(s) Form No.

GEO.263

220 MORRISSEY BOULEVARD, BOSTON, MASSACHUSETTS 02125

National Register of Historic Places Criteria Statement Form

Check all that apply:

- ☐ Individually eligible ☒ Eligible **only** in a historic district
☒ Contributing to a potential historic district ☐ Potential historic district

Criteria: ☒ **A** ☐ **B** ☒ **C** ☐ **D**

Criteria Considerations: ☐ **A** ☐ **B** ☐ **C** ☐ **D** ☐ **E** ☐ **F** ☐ **G**

Statement of Significance by Neil Larson

The criteria that are checked in the above sections must be justified here.

The Isley-Watson House, built about 1860, is a representative example of late nineteenth-century domestic architecture in the town center. Its end house plan and front-gable orientation has characteristics in common with other houses from this period in Georgetown. The house was built for Harriet Goodridge Isley, the widow of William Isley, and she lived here with her son Jonathan Isley, who worked as a blacksmith, and his family. In 1877 Harriet Goodridge Isley died, and probate records document that she owned a house, barn, and land valued at \$1000 and \$160.36 in personal property. She had left her daughter Ann Isley Dunham the use of the front room and front bedroom in the North Street house and right to pass to the cellar, well, and barn for her lifetime, as well as her bedding, clothing, and any cash left after her debts were paid. She left her son Jonathan Adams Isley the rest of her real and personal estate. In 1917 the property was conveyed to Thomas A. Watson whose family owned it until 1950. Thomas Watson was proprietor of a confectionary and ice cream store at 11 West Main Street. The 1920 census shows him as a restaurant proprietor and in 1930 he is shown as chef in his own restaurant, known as Watson's Lunch. His wife, Mildred, formerly a milliner, worked there as a waitress. The property meets National Register criteria A and C as a contributing feature in a potential historic district in the town center, the boundaries of which have yet to be determined.