

INVENTORY FORM B CONTINUATION SHEET

GEORGETOWN

64 North Street

MASSACHUSETTS HISTORICAL COMMISSION

Area(s) Form No.

GEO.262

220 MORRISSEY BOULEVARD, BOSTON, MASSACHUSETTS 02125

FORM B – BUILDING

MASSACHUSETTS HISTORICAL COMMISSION  
MASSACHUSETTS ARCHIVES BUILDING  
220 MORRISSEY BOULEVARD  
BOSTON, MASSACHUSETTS 02125

Photograph



View from SE.

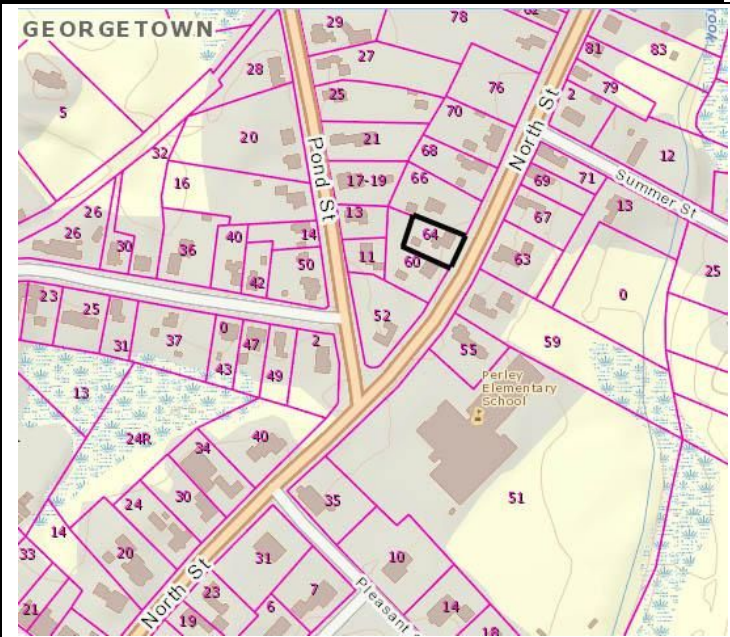

Source: Mass GIS Oliver Parcel Viewer

**Recorded by:** Kathryn Grover & Neil Larson  
**Organization:** Town of Georgetown Historical Commission  
**Date:** June 2017

Locus Map (north at top)

# INVENTORY FORM B CONTINUATION SHEET

GEORGETOWN

64 North Street

MASSACHUSETTS HISTORICAL COMMISSION

Area(s) Form No.

GEO.262

220 MORRISSEY BOULEVARD, BOSTON, MASSACHUSETTS 02125

Assessor's Number USGS Quad Area(s) Form Number

**Setting:** Part of a densely developed streetscape of single-family houses within the village center.

11A-171

Georgetown

GEO.262

**Town/City:** Georgetown

**Place:** (*neighborhood or village*):  
Georgetown Center

**Address:** 64 North Street

**Historic Name:** Hannah F. & Caleb S. Jackson House

**Uses:** Present: single family residential

Original: single family residential

**Date of Construction:** ca. 1873

**Source:** deeds & visual assessment

**Style/Form:** Classical Revival

**Architect/Builder:** unknown

**Exterior Material:**

Foundation: brick

Wall/Trim: wood clapboards

Roof: asphalt shingles

**Outbuildings/Secondary Structures:**  
garage

**Major Alterations** (*with dates*):

Wing added SW corner, late 19<sup>th</sup> century

**Condition:** good

**Moved:** no ☒ yes ☐ **Date:**

**Acreage:** 0.21 acre

# INVENTORY FORM B CONTINUATION SHEET

GEORGETOWN

64 North Street

MASSACHUSETTS HISTORICAL COMMISSION

Area(s) Form No.

GEO.262

220 MORRISSEY BOULEVARD, BOSTON, MASSACHUSETTS 02125

☒ Recommended for listing in the National Register of Historic Places.

*If checked, you must attach a completed National Register Criteria Statement form.*

## ARCHITECTURAL DESCRIPTION:

The Hannah F. and Caleb S. Jackson House is a two-story wood frame single dwelling with a gable roof built about 1873. Its bilaterally symmetrical form and double-pile center-passage plan with chimneys between front and rear rooms (one chimney is gone) reflects the persistence of Classically oriented house design in New England. The three-bay front façade with its center entrance was an adaptation of the traditional five-bay façade that became popular in the mid-nineteenth century. Trim along the roof edge and on the two gabled front dormers follows the Classical mode. End walls also are symmetrical with two windows on each floor and single attic windows centered in the gables. The fenestration on the southerly end was altered when a two-story flat-roof wing was added to the southwest corner of the house later in the 19<sup>th</sup> century. The street façade of the wing appears altered as well, perhaps by the removal of an earlier porch.

The house is situated on the north side of its lot set back behind a small yard. A one-story wood frame two-car garage with a front gable roof and wood board-and-batten siding is located in the southwest corner of the small lot at the end of a driveway running along the southerly lot line.

## HISTORICAL NARRATIVE

In December 1872 Daniel Pierce, his son Gilman, and daughter Mary Elizabeth sold a lot of land taken from the north side of their property (52 North Street, GEO.258) to Hannah F. Jackson for \$266.<sup>1</sup> Born about 1829 in Rowley, Hannah Foster Jackson was the daughter of John and Hannah D. Foster and had married Georgetown shoemaker Caleb S. Jackson in 1850; he died in 1876. The 1880 census shows Hannah Jackson in the house with her son John Foster Jackson, an upper leather cutter, her 73-year-old mother Hannah D. Foster, and her sister Eliza, who was disabled and had lived with her since she married. In 1888 son John, a furniture dealer, married Lucy R. Goodwin of Georgetown, and the 1900 census shows Hannah F. Jackson, her sister Eliza, and her son John in the household with his wife and their three children, as well as Lucy Goodwin Jackson's father Josiah Goodwin. By then John F. Jackson was working as an undertaker.

In 1900 Hannah Foster Jackson died, and eight years later Lucy Goodwin Jackson died. By 1920 John Jackson was a realtor and occupied the house with his sons Richmond M., then a missionary abroad, and Herbert, born in 1898. In 1924 he sold 64 North Street to Stedman Smith, who sold it five years later to Josephine Carter Larkin, who had been living with her husband and her parents, Luther F. and Elizabeth Kent Carter, at 52 North Street.<sup>2</sup> She had married streetcar conductor Samuel Larkin, a native of Newbury in 1905 and by 1910 the couple was living on Andover Street. The 1930 census shows them living at 62 North Street—actually 64—along with a boarder, the widow Emma Chaplin. Samuel Larkin was then a shoe factory salesman. After his death in 1937, Josephine Larkin rented part of the house to shoe cutter Warren Flanders and his wife Phyllis.

In 1944 Josephine Larkin sold the house to Jessie C. Larkin of Medford, who owned it for a decade.<sup>3</sup> Jessie Larkin might have been her sister-in-law; Jessie's husband, who had died in 1931, was Nicholas Byron Larkin, son of Charles O. and Josephine Keyon Larkin of Georgetown. She owned 64 North Street until 1955. Current owners Peter G. and Georgette K. Dowd acquired the property in 1967.<sup>4</sup>

<sup>1</sup> Daniel Pierce, Gilman Pierce, and Mary E. Pierce to Hannah F. Jackson, 14 December 1872, SECD 871:58.

<sup>2</sup> John F. Jackson to Stedman Smith, 23 August 1924, SECD 2609:597; Stedman Smith to Josephine Carter Larkin, 25 July 1929, SECD 2814:237.

<sup>3</sup> Josephine Carter Larkin to Jessie C. Larkin, Medford MA, 11 January 1944, SECD 3359:102;

<sup>4</sup> Daniel M. and Nancy A. Dorgan to Peter G. and Georgette K. Dowd, 9 May 1967, SECD 5441:777.

# INVENTORY FORM B CONTINUATION SHEET

GEORGETOWN

64 North Street

MASSACHUSETTS HISTORICAL COMMISSION

Area(s) Form No.

GEO.262

220 MORRISSEY BOULEVARD, BOSTON, MASSACHUSETTS 02125

## BIBLIOGRAPHY and/or REFERENCES

AmericanAncestors.org.

Ancestry.com.

Assessor's Records, Georgetown and Rowley. 1883, 1902, 1920, 1933.

Bureau of the Census. United States Census, 1790-1930.

Nelson, Henry M. "Town of Georgetown History." In Hurd, D. Hamilton. *History of Essex County, Massachusetts, with Biographical Sketches of Many of Its Pioneers and Prominent Men*. Vol. 1. Philadelphia: J. W. Lewis and Co., 1888.

Southern Essex County Registry of Deeds website, salemdeeds.com.

## DIRECTORIES

*The Essex County Directory*. 1866. Boston: Innes & Niles, 1866.

*Essex County History and Directory*. Boston: C. A. & J. F. Wood, 1870.

*Resident and Business Directory of Groveland and Georgetown, Mass., for 1885-1886*. Needham, MA: Local Directory Publishing Co., 1885.

*Georgetown, Boxford, Byfield, Newbury, and West Newbury, Massachusetts, Directory*. Boston: W. E. Shaw, 1901-2, 1905.

North Essex Directory for Boxford, Georgetown, Merrimac, Newbury, Rowley, Salisbury, West Newbury. Salem, MA: Henry M. Meek Publishing Co., 1907, 1909-10, 1912, 1914-15, 1916-17, 1918, 1925.

*Ipswich, Boxford, Byfield, Georgetown, Newbury, Rowley, Salisbury, Salisbury Beach, Topsfield, West Newbury Directory*. Vol. 1, 1932-'34. Beverly, MA, and Portland, ME: Crowley & Lunt, 1932.

*Haverhill, Mass. Suburban Directory for Georgetown, Groveland, Merrimac and West Newbury 1940*. North Hampton, NH: Crosby Publishing Co., 1940.

*Ipswich, Boxford, Georgetown, Middleton, Newbury, Rowley, Salisbury, Topsfield, West Newbury Directory 1957*. New Haven, CT: Price & Lee Co., 1957.

## MAPS

Map of Georgetown. 1856. In Walling, H. F. *A Topographical Map Essex County Massachusetts*. Boston: Smith and Morley, 1856.

*Atlas of Essex County, Massachusetts*. Philadelphia: D. G. Beers and Co., 1872). Plates 59 and 61.

"Town of Georgetown Mass." and "Village of Georgetown Mass." In *Atlas of Essex County, Massachusetts* (Boston: George H. Walker, 1884).

"Georgetown, Mass. 1887." Drawn and Published by George E. Norris, Brockton, Massachusetts. Troy, NY: Burleigh Lithographic Establishment, 1887."

INVENTORY FORM B CONTINUATION SHEET

GEORGETOWN

64 North Street

MASSACHUSETTS HISTORICAL COMMISSION

Area(s) Form No.

GEO.262
---------

220 MORRISSEY BOULEVARD, BOSTON, MASSACHUSETTS 02125

PHOTOGRAPHS (all photos by Neil Larson, 2017)



View from SE.

# INVENTORY FORM B CONTINUATION SHEET

GEORGETOWN

64 North Street

MASSACHUSETTS HISTORICAL COMMISSION

Area(s) Form No.

GEO.262

220 MORRISSEY BOULEVARD, BOSTON, MASSACHUSETTS 02125



View from NE.

## National Register of Historic Places Criteria Statement Form

Check all that apply:

- ☐ Individually eligible ☒ Eligible **only** in a historic district  
☒ Contributing to a potential historic district ☐ Potential historic district

Criteria: ☒ A ☐ B ☒ C ☐ D

Criteria Considerations: ☐ A ☐ B ☐ C ☐ D ☐ E ☐ F ☐ G

Statement of Significance by Neil Larson

*Follow Massachusetts Historical Commission Survey Manual instructions for completing this form.*

INVENTORY FORM B CONTINUATION SHEET

GEORGETOWN

64 North Street

MASSACHUSETTS HISTORICAL COMMISSION

Area(s) Form No.

GEO.262
---------

220 MORRISSEY BOULEVARD, BOSTON, MASSACHUSETTS 02125

*The criteria that are checked in the above sections must be justified here.*

The Hannah F. and Caleb S. Jackson House, built about 1873, is an intact representative example of late nineteenth-century domestic architecture in the town center. It has characteristics in common with other houses from this period in Georgetown, notably the persistent preservation of bilaterally symmetrical Classical plans and elevations. The lot was created and sold in 1872 to Hannah F. Jackson, wife of Georgetown shoemaker Caleb S. Jackson, for whom the house was built. The family lived in the house until 1924 and afterwards it was the home of Josephine Carter Larkin and her husband, streetcar conductor Samuel Larkin. The property meets National Register criteria A and C as a contributing feature in a potential historic district in the town center, the boundaries of which have yet to be determined.