

INVENTORY FORM B CONTINUATION SHEET

GEORGETOWN

62 Pond Street

MASSACHUSETTS HISTORICAL COMMISSION

Area(s) Form No.

GEO.294

220 MORRISSEY BOULEVARD, BOSTON, MASSACHUSETTS 02125

FORM B – BUILDING

MASSACHUSETTS HISTORICAL COMMISSION
MASSACHUSETTS ARCHIVES BUILDING
220 MORRISSEY BOULEVARD
BOSTON, MASSACHUSETTS 02125

Photograph



View from north.

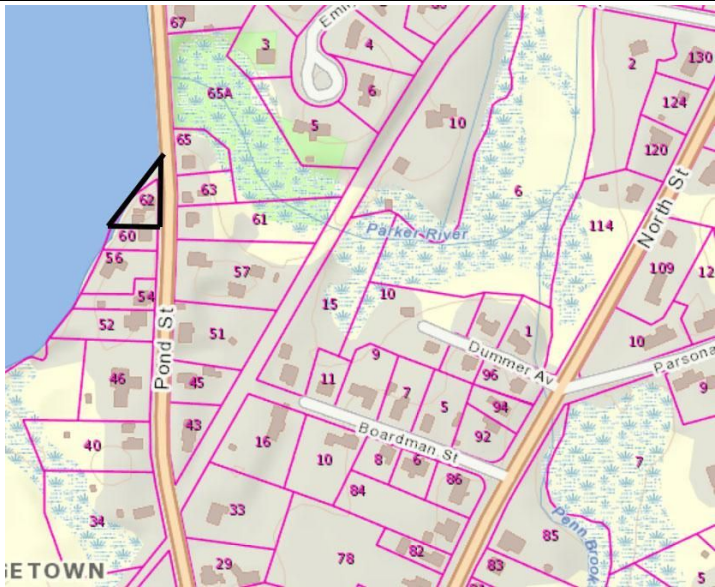

Source: Mass GIS Oliver Parcel Viewer

Recorded by: Kathryn Grover & Neil Larson
Organization: Town of Georgetown Historical Commission
Date: June 2017

Locus Map (north at top)

INVENTORY FORM B CONTINUATION SHEET

GEORGETOWN

62 Pond Street

MASSACHUSETTS HISTORICAL COMMISSION

Area(s) Form No.

GEO.294

220 MORRISSEY BOULEVARD, BOSTON, MASSACHUSETTS 02125

Assessor's Number USGS Quad Area(s) Form Number

11B-13

Georgetown

GEO.294

Setting: Concentrated neighborhood of single-family homes in town center; backs up on pond.

Town/City: Georgetown

Place: (*neighborhood or village*):
Pentucket Pond

Address: 62 Pond Street

Historic Name: Bettis-Buckley-Powell House

Uses: Present: single family residential

Original: single family residential

Date of Construction: ca. 1850

Source: deeds & visual assessment

Style/Form: Italianate

Architect/Builder: unknown

Exterior Material:

Foundation: stone

Wall/Trim: vinyl clapboards

Roof: asphalt shingles

Outbuildings/Secondary Structures:

Garage (attached)

Major Alterations (*with dates*):

Garage added, mid-20th century

Vinyl siding added

Condition: fair

Moved: no ☒ yes ☐ **Date:**

Acreage: 0.05 acre

INVENTORY FORM B CONTINUATION SHEET

GEORGETOWN

62 Pond Street

MASSACHUSETTS HISTORICAL COMMISSION

Area(s) Form No.

GEO.294

220 MORRISSEY BOULEVARD, BOSTON, MASSACHUSETTS 02125

☐ Recommended for listing in the National Register of Historic Places.

If checked, you must attach a completed National Register Criteria Statement form.

ARCHITECTURAL DESCRIPTION:

The Bettis-Buckley-Powell House is a story-and-a-half wood frame single dwelling with a gable roof built about 1850. It has a single-pile center hall plan with a one-story kitchen wing on the south side of the rear wall. A three-bay front façade has a center entrance with a flat-roof hood mounted on ornate scrolled brackets. The eaves are distinguished by a Classical cornice partially obscured by added vinyl siding. The end walls contain single windows centered on both stories. The kitchen occupies a short cross-gable wing and evidently shares space within the rear of the house where a chimney is located. What appears to have been a one-story one-car garage is attached to the south side of the kitchen wing; it has been converted to domestic use.

The house is centered on a small triangular lot where Pond Street intersects the shoreline of Pentucket Pond. A driveway runs along the south lot line and terminates at the former garage.

HISTORICAL NARRATIVE

The 1856 map of Georgetown Center labels the house now numbered 62 Pond Street "A. Batis" for Andrew Bettis, born in Rowley in 1796 to Robert and Elcy Bridges Bettis. Robert Bettis had been born in Pelham, New Hampshire, and married in Rowley the same year that Andrew was born. In 1822 Andrew Bettis married Martha Pierce, the daughter of Daniel and Hannah Pierce, who lived at the junction of North and Pond Streets (52 North Street, GEO.258), and the couple had four children—Mercy Maria, born in 1822, Elizabeth Nelson, born 1824; Matilda Adams, born 1828; and Julia Ann, born in 1836. Mercy Maria Bettis married Uriah Pillsbury in 1843, and they lived with their family at 56 Pond Street. In August 1851 Pillsbury sold Martha Battis a house lot with buildings just north of his on Pentucket Pond for \$15 but reserved the "ice privileges" on the pond to George J. Tenney and Samuel Little, who had fairly recently begun a commercial ice harvesting operation there.¹ Andrew Bettis had lived on or near West Main Street, just southwest of this lot, since at least 1830. The census enumeration suggests that the house was standing by 1850. That year Andrew Bettis, his wife Martha, and their daughter Julia were listed in a household just after that of Uriah Pillsbury, and in 1855 Bettis, his wife, and Uriah's son Joseph Pillsbury are listed just before the Pillsbury household.

In 1858 Martha Pierce Bettis died, and the 1860 census shows Andrew Bettis in the house as a 56-year-old day laborer with \$200 in real property. He had the income of boarding shoemaker Galone Morse, his wife (a shoe binder), and their infant son James. In August 1860 Andrew Bettis sold 62 Pond Street to Daniel Buckley with a lot of one-eighth of an acre, and he died in 1864.²

Born in Ireland about 1830, Daniel Buckley was working as a laborer and living in Georgetown when he married Irish immigrant Ellen Welch in Haverhill in 1857. The couple had a daughter, Julia, born about 1860, and Daniel Buckley died in 1864 (of "rum," according to his death record). He left \$300 in real property and no personal estate. The 1870 census shows his widow Ellen in the house with real estate of identical value; she and her daughter had rental income from shoe factory worker Andrew Jackson and his wife Elizabeth, who shared 62 Pond Street with them. Ellen Buckley is shown alone in the house in the 1880 census, and she died in 1888 at the age of 70.

The 62 Pond Street house was owned by Georgetown Savings Bank in 1897; in that year Margaret J. Bryant bought the property for \$250.³ The house remained in her family until 1964. Margaret J. Lane was born in Ireland in 1852 and had come to

¹ Uriah F. Pillsbury to Martha Battis, 1 August 1851, SECD 453:236.

² Andrew Bettis to Daniel Buckley, 15 August 1860, SECD 611:153.

³ Georgetown Savings Bank to Margaret J. Bryant, 13 May 1897, SECD 1512:371

INVENTORY FORM B CONTINUATION SHEET

GEORGETOWN

62 Pond Street

MASSACHUSETTS HISTORICAL COMMISSION

Area(s) Form No.

GEO.294

220 MORRISSEY BOULEVARD, BOSTON, MASSACHUSETTS 02125

the United States between 1860 and 1862. She married shoe factory worker Charles F. Bryant by 1880, and the 1900 census shows them in this neighborhood with their daughter Eleanor, born in 1892. What became of Charles Bryant is unclear, but by 1910 Margaret J. Bryant is shown as a washerwoman living on Pond Street possibly by herself; the next enumerated household was that of California-born plumber John F. Galvin, his wife Hannah, their adult son William, and a niece, and the house was owned by Hannah T. Galvin after Margaret Bryant died in 1927. In 1931 Galvin, possibly Bryant's sister-in-law, sold 62 Pond Street to Frederick C. Lane, who may also have been related; she reserved a life estate for herself in the house.⁴ The 1932 directory shows Hannah Galvin as owner of 62 Pond Street and Frederick C. Lane, the city sports editor for the *Boston American*, as boarding there with his wife Bernice. Lane appears to have remained in the house until his death, before January 1957. By 1961 Lane's daughters Gertrude B. Lane and Geraldine Lane Darmofel of Revere owned the property, and they sold it to current owners Edward C. and Shirley Powell in 1964.⁵

BIBLIOGRAPHY and/or REFERENCES

AmericanAncestors.org.

Ancestry.com.

Assessor's Records, Georgetown and Rowley. 1883, 1902, 1920, 1933.

Bureau of the Census. United States Census, 1790-1930.

Nelson, Henry M. "Town of Georgetown History." In Hurd, D. Hamilton. *History of Essex County, Massachusetts, with Biographical Sketches of Many of Its Pioneers and Prominent Men*. Vol. 1. Philadelphia: J. W. Lewis and Co., 1888.

Southern Essex County Registry of Deeds website, salemdeeds.com.

DIRECTORIES

Georgetown, Boxford, Byfield, Newbury, and West Newbury, Massachusetts, Directory. Boston: W. E. Shaw, 1901-2, 1905.

North Essex Directory for Boxford, Georgetown, Merrimac, Newbury, Rowley, Salisbury, West Newbury. Salem, MA: Henry M. Meek Publishing Co., 1907, 1909-10, 1912, 1914-15, 1916-17, 1918, 1925.

Ipswich, Boxford, Byfield, Georgetown, Newbury, Rowley, Salisbury, Salisbury Beach, Topsfield, West Newbury Directory. Vol. 1, 1932-'34. Beverly, MA, and Portland, ME: Crowley & Lunt, 1932.*Haverhill, Mass. Suburban Directory for Georgetown, Groveland, Merrimac and West Newbury 1940*. North Hampton, NH: Crosby Publishing Co., 1940.*Ipswich, Boxford, Georgetown, Middleton, Newbury, Rowley, Salisbury, Topsfield, West Newbury Directory 1957*. New Haven, CT: Price & Lee Co., 1957.

MAPS

Map of Georgetown. 1856. In Walling, H. F. *A Topographical Map Essex County Massachusetts*. Boston: Smith and Morley, 1856.*Atlas of Essex County, Massachusetts*. Philadelphia: D. G. Beers and Co., 1872). Plates 59 and 61."Town of Georgetown Mass." and "Village of Georgetown Mass." In *Atlas of Essex County, Massachusetts* (Boston: George H. Walker, 1884).

⁴ Hannah T. Galvin to Frederick C. Lane, 21 October 1931, SECD 3060:537. Hannah Gavlin was the wife of plumer John F. Galvin, whose parents were Cornelius and Catherine Lane Galving of Ireland.

⁵ Gertrude B. Lane, Geraldine T. Darmofel, and Frederick C. Lane Jr., all Revere MA, and Virginia M. Wall to A. Marie McCarthy, Somerville MA, 21 January 1957, SECD 4341:568; Jane M. McDonough, Revere MA, to Gertrude B. Lane and Geraldine T. Lane Darmofel, Revere MA, 9 June 1961, SECD 4778:385; Geraldine T. Darmofel fka Lane, Revere MA, to Edward C. and Shirley Powell, 11 September 1964, SECD 5205:662.

INVENTORY FORM B CONTINUATION SHEET

GEORGETOWN

62 Pond Street

MASSACHUSETTS HISTORICAL COMMISSION

Area(s) Form No.

GEO.294

220 MORRISSEY BOULEVARD, BOSTON, MASSACHUSETTS 02125

PHOTOGRAPHS (all photos by Neil Larson, 2017)



View from SE.