

# INVENTORY FORM B CONTINUATION SHEET

GEORGETOWN

2 Moulton Street

MASSACHUSETTS HISTORICAL COMMISSION

Area(s) Form No.

GEO.236

220 MORRISSEY BOULEVARD, BOSTON, MASSACHUSETTS 02125

## FORM B – BUILDING

Source: Mass GIS Oliver Parcel Viewer

MASSACHUSETTS HISTORICAL COMMISSION  
MASSACHUSETTS ARCHIVES BUILDING  
220 MORRISSEY BOULEVARD  
BOSTON, MASSACHUSETTS 02125

**Recorded by:** Kathryn Grover & Neil Larson

**Organization:** Town of Georgetown Historical Commission

**Date:** June 2017

### Photograph



View from north.

### Locus Map (north at top)

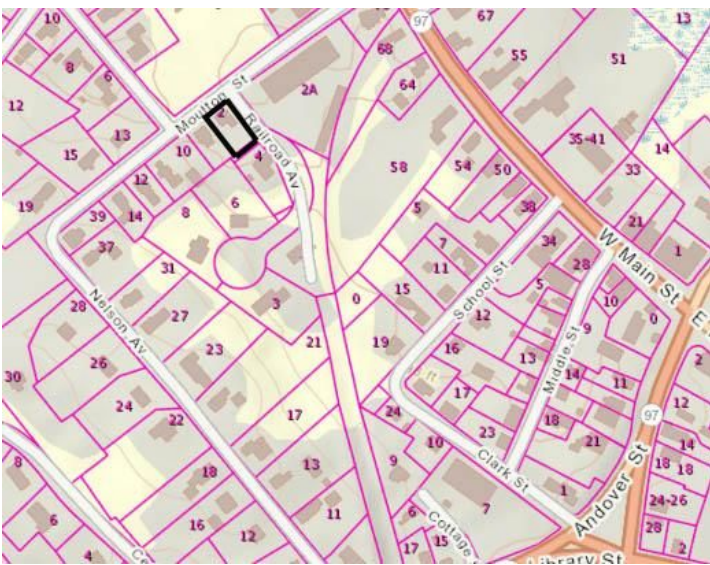

Follow Massachusetts Historical Commission Survey Manual instructions for completing this form.

# INVENTORY FORM B CONTINUATION SHEET

GEORGETOWN

2 Moulton Street

MASSACHUSETTS HISTORICAL COMMISSION

Area(s) Form No.

GEO.236

220 MORRISSEY BOULEVARD, BOSTON, MASSACHUSETTS 02125

Assessor's Number USGS Quad Area(s) Form Number

6C-112

Georgetown

GEO.236

**Setting:** Residential neighborhood developed in late 19<sup>th</sup>-century adjacent to commercial area of town center.

**Town/City:** Georgetown

**Place:** (*neighborhood or village*):  
Georgetown Center

**Address:** 2 Moulton Street

**Historic Name:** Dwinell-Rogers House

**Uses:** Present: single family residential  
Original: single family residential

**Date of Construction:** ca. 1875

**Source:** deeds & visual assessment

**Style/Form:** Italianate

**Architect/Builder:** Joseph Watson, West Newbury  
probable builder

**Exterior Material:**

Foundation: stone

Wall/Trim: wood shingles

Roof: asphalt shingles

**Outbuildings/Secondary Structures:**  
Nonr

**Major Alterations** (*with dates*):  
Window sash replaced

**Condition:** good

**Moved:** no ☒ yes ☐ **Date:**

**Acreage:** 0.17 acre

# INVENTORY FORM B CONTINUATION SHEET

GEORGETOWN

2 Moulton Street

MASSACHUSETTS HISTORICAL COMMISSION

Area(s) Form No.

GEO.236

220 MORRISSEY BOULEVARD, BOSTON, MASSACHUSETTS 02125

☐ Recommended for listing in the National Register of Historic Places.

*If checked, you must attach a completed National Register Criteria Statement form.*

## ARCHITECTURAL DESCRIPTION:

The Dwinell-Rogers House, built about 1875, is a two-story, wood frame single dwelling with a flat gable roof. Located adjacent to the railroad corridor, the house was designed to house factory or railroad workers. It is distinguished by robust Italianate ornament along the eave line of its low-pitched hipped roof, notably deep soffits, paired brackets and dentil bands. Its three-bay street façade is completely fenestrated; the entrance to the house is located on the front of a one-story, enclosed porch or vestibule on the northeast side of the building. This vestibule traverses the entire side wall to link up with a one-story kitchen ell on the rear, with the same Italianate roof-edge decoration. The second story of the northeast wall is blank suggesting that a staircase is contained in this location just off the entry. There are two windows on each floor of the southwest side. The rear wall and wing are irregularly fenestrated; the kitchen entrance is on the rear of the wing. The house is sited at the front of the small lot, close to its boundaries on the front and sides with the remaining space consumed by a tall, dense hedge. A break in the hedge on Railroad Avenue at the rear property provides access to a parking area in the rear yard. There are no outbuildings.

## HISTORICAL NARRATIVE

In 1853 Georgetown shoe manufacturer Daniel E. Moulton bought 16 acres from the estate of late Nathaniel Nelson, who lived at the northwest corner of Andover Street and Nelson Avenue. The tract embraced the properties now addressed on Moulton Street.<sup>1</sup> Between 1873 and 1883 he subdivided the parcel, mostly into lots of 120 by 60 feet. He sold three undeveloped lots by 1875 and then had houses built on at least three other lots—at 2 and 10 Moulton Street and 39 Nelson Avenue, at the southeast corner of the intersection of those two streets. Moulton may have been inspired to develop housing for the town's shoe and other workers by the fact that Nathaniel Nelson's heirs laid out and had begun to develop land on both sides of Nelson Avenue as early as 1849.

In 1875 Moulton conveyed an undivided half of the subject property with the buildings thereon to English-born house carpenter Joseph Watson of West Newbury, probably in return for constructing the extant house. In 1883 Moulton sold the lot and its buildings to Mary A. Dwinell, the adopted daughter of Samuel P. Jewett and the wife of shoemaker Jacob Dwinell, who may have been renting the house in 1880; her family is enumerated in the census next to the family of Michael Buckley, a longtime householder just to the southwest. The 1880 census lists the Dwinells with their 16-year-old daughter Edith. In 1888 Edith Dwinell married woolen mill dyer Samuel E. Talpey, a native of Kennebunkport, Maine, then living in Lawrence. In 1895 Jacob and Mary Dwinell deeded 2 Moulton Street to the Talpeys but probably remained in the house, as the Talpeys were living in Auburn, New York. Mary Dwinell died in June 1898, and by 1900 Jacob had moved in with his daughter Edith's family in western New York.<sup>2</sup>

By 1900 the Tapleys were renting the Moulton Street house to Roderick A. and Henrietta Harvey Rogers, and the 1900 census enumerated them there with their children Henry, Alphonso Augustus, Marjorie, and Fred. Roderick Rogers worked as a railroad brakeman, and the property then bordered the rail line and was steps away from Georgetown depot. Roderick Rogers died in 1910 and the census taken that year shows his widow renting the house and employed as a boardinghouse keeper, although her household contained only her sons Henry, a baker, and Augustus, a shoe factory edge setter, and her married daughter Marjorie Young with her young children Doris and Fred. Henry H. Rogers bought the house for \$1100 from Edith Tapley the next year.<sup>3</sup> The 1925 directory shows Henrietta and her son Henry at 2 Moulton Street, as does the 1930 census.

<sup>1</sup> Joseph Kimball and Jer. P. Jones, administrators, estate Nathaniel Nelson, to Daniel E. Moulton, 15 September 1853, SECD 487:99.

<sup>2</sup> Daniel E. Moulton to Joseph Watson, West Newbury, 21 June 1875, SECD 974:254; Daniel E. Moulton to Mary A. Dwinell, 1 February 1883, SECD 1100:240; Jacob and Mary A. Dwinell to Samuel E. Talpey, 10 June 1895, SECD 1448:316.

<sup>3</sup> Edith V. Talpey, Auburn NY, to Henry H. Rogers, 27 July 1911, SECD 2100:285.

# INVENTORY FORM B CONTINUATION SHEET

GEORGETOWN

2 Moulton Street

MASSACHUSETTS HISTORICAL COMMISSION

Area(s) Form No.

GEO.236

220 MORRISSEY BOULEVARD, BOSTON, MASSACHUSETTS 02125

Henrietta Harvey Rogers died in 1939, and Henry H. Rogers had died by August 1962. By Henrietta Rogers's will, the Moulton Street property was devised to her daughter Doris A. Marston, a Georgetown realtor. Apparently Henry's title was conveyed to her in Probate Court. In 1962 Marston sold it to Joseph R. and Lillian I. Maynard, who owned it for two decades. The property changed hands often after 1983. In 1996 Joseph D. Sordillo, then of Merrimac, bought the property, and its current owners are Joseph D. Sordillo Jr. and Tracy A. Sordillo.<sup>4</sup>

## BIBLIOGRAPHY and/or REFERENCES

AmericanAncestors.org.

Ancestry.com.

Assessor's Records, Georgetown and Rowley. 1883, 1902, 1920, 1933.

Bureau of the Census. United States Census, 1790-1930.

Lainhart, Ann S. "1855 and 1865 Massachusetts State Censuses for Georgetown." Boston: Ann S. Lainhart, 1987.

Nelson, Henry M. "Town of Georgetown History." In Hurd, D. Hamilton. *History of Essex County, Massachusetts, with Biographical Sketches of Many of Its Pioneers and Prominent Men*. Vol. 1. Philadelphia: J. W. Lewis and Co., 1888.

Southern Essex County Registry of Deeds website, salemdeeds.com.

## DIRECTORIES

*The Essex County Directory*. 1866. Boston: Innes & Niles, 1866.

*Essex County History and Directory*. Boston: C. A. & J. F. Wood, 1870.

*Resident and Business Directory of Groveland and Georgetown, Mass., for 1885-1886*. Needham, MA: Local Directory Publishing Co., 1885.

*Georgetown, Boxford, Byfield, Newbury, and West Newbury, Massachusetts, Directory*. Boston: W. E. Shaw, 1901-2, 1905.

North Essex Directory for Boxford, Georgetown, Merrimac, Newbury, Rowley, Salisbury, West Newbury. Salem, MA: Henry M. Meek Publishing Co., 1907, 1909-10, 1912, 1914-15, 1916-17, 1918, 1925.

*Ipswich, Boxford, Byfield, Georgetown, Newbury, Rowley, Salisbury, Salisbury Beach, Topsfield, West Newbury Directory*. Vol. 1, 1932-'34. Beverly, MA, and Portland, ME: Crowley & Lunt, 1932.

*Haverhill, Mass. Suburban Directory for Georgetown, Groveland, Merrimac and West Newbury 1940*. North Hampton, NH: Crosby Publishing Co., 1940.

*Ipswich, Boxford, Georgetown, Middleton, Newbury, Rowley, Salisbury, Topsfield, West Newbury Directory 1957*. New Haven, CT: Price & Lee Co., 1957.

## MAPS

*Atlas of Essex County, Massachusetts*. Philadelphia: D. G. Beers and Co., 1872). Plates 59 and 61.

"Town of Georgetown Mass." and "Village of Georgetown Mass." In *Atlas of Essex County, Massachusetts* (Boston: George H. Walker, 1884).

"Georgetown, Mass. 1887." Drawn and Published by George E. Norris, Brockton, Massachusetts. Troy, NY: Burleigh Lithographic Establishment, 1887."

*Insurance Maps of Haverhill Including Bradford, Groveland & Georgetown, Massachusetts*. New York: Sanborn-Perris Map Co., 1893; Sanborn Map Co., 1906, 1949.

<sup>4</sup> Doris A. Marston to Joseph R. and Lillian I. Maynard, 18 August 1962, SECD 5000:13; Joseph R. and Lillian I. Maynard to Catherine I. Scholtz, 12 July 1983, SECD 7163:143; Secretary of Veterans Affairs, United States, to Joseph D. Sordillo, Merrimac MA, 20 June 1996, SECD 13636:182; Joseph D. Sordillo (aka Jr) to Joseph D. Sordillo Jr. and Tracy A. Sordillo, 9 October 2003, SECD 21940:64.

INVENTORY FORM B CONTINUATION SHEET

GEORGETOWN

2 Moulton Street

MASSACHUSETTS HISTORICAL COMMISSION

Area(s) Form No.

GEO.236
---------

220 MORRISSEY BOULEVARD, BOSTON, MASSACHUSETTS 02125

PHOTOGRAPHS (all photos by Neil Larson, 2017)



View from west.



# INVENTORY FORM B CONTINUATION SHEET

GEORGETOWN

2 Moulton Street

MASSACHUSETTS HISTORICAL COMMISSION

Area(s) Form No.

GEO.236

220 MORRISSEY BOULEVARD, BOSTON, MASSACHUSETTS 02125



View from east.



Aerial view from north. Source [bing.com/maps](http://bing.com/maps).

INVENTORY FORM B CONTINUATION SHEET

GEORGETOWN

2 Moulton Street

MASSACHUSETTS HISTORICAL COMMISSION

Area(s) Form No.

GEO.236
---------

220 MORRISSEY BOULEVARD, BOSTON, MASSACHUSETTS 02125



Aerial view from south. Source [bing.com/maps](https://www.bing.com/maps).