

INVENTORY FORM B CONTINUATION SHEET

GEORGETOWN

193 Jewett Street

MASSACHUSETTS HISTORICAL COMMISSION

Area(s) Form No.

GEO.234
GEO.235

220 MORRISSEY BOULEVARD, BOSTON, MASSACHUSETTS 02125

FORM B – BUILDING

MASSACHUSETTS HISTORICAL COMMISSION
MASSACHUSETTS ARCHIVES BUILDING
220 MORRISSEY BOULEVARD
BOSTON, MASSACHUSETTS 02125

Photograph



View from north.

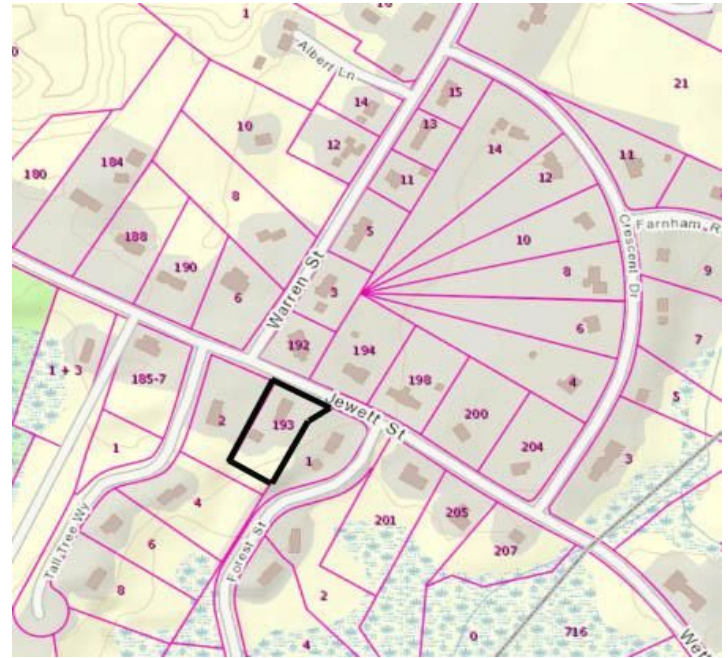

Source: Mass GIS Oliver Parcel Viewer

Recorded by: Kathryn Grover & Neil Larson

Organization: Town of Georgetown Historical Commission

Date: June 2017

Locus Map (north at top)

INVENTORY FORM B CONTINUATION SHEET

GEORGETOWN

193 Jewett Street

MASSACHUSETTS HISTORICAL COMMISSION

Area(s) Form No.

GEO.234 GEO.235

220 MORRISSEY BOULEVARD, BOSTON, MASSACHUSETTS 02125

Assessor's Number	USGS Quad	Area(s)	Form Number	Setting: Old rural crossroads subdivided for suburban development
19-17	Georgetown		GEO.234 GEO.235	

Town/City: Georgetown

Place: (neighborhood or village):
Byfield Parish

Address: 193 Jewett Street

Historic Name: Cheney-Howe House & Barn

Uses: Present: single family residential
Original: multiple family residential

Date of Construction: ca. 1798, ca. 1855

Source: deeds & visual assessment

Style/Form: Classical Revival

Architect/Builder: unknown

Exterior Material:

Foundation: stone
Wall/Trim: wood clapboards
Roof: asphalt shingles

Outbuildings/Secondary Structures:

Domestic barn, ca. 1850

Major Alterations (with dates):

Second story added, ca. 1855
Rear addition, ca. 2000

Condition: good

Moved: no ☒ yes ☐ Date:

Acreage: 0.93 acre

INVENTORY FORM B CONTINUATION SHEET

GEORGETOWN

193 Jewett Street

MASSACHUSETTS HISTORICAL COMMISSION

Area(s) Form No.

GEO.234
GEO.235

220 MORRISSEY BOULEVARD, BOSTON, MASSACHUSETTS 02125

☐ Recommended for listing in the National Register of Historic Places.

If checked, you must attach a completed National Register Criteria Statement form.

ARCHITECTURAL DESCRIPTION:

The Cheney-Howe House, built about 1798, appears to have originated as a story-and-a-half wood frame single dwelling with a gable roof and center-chimney plan. By 1855 it was elevated to two stories in height when it was adapted to a two-family dwelling. The original five-bay front façade with a center entrance was not duplicated on the added second story; rather three windows instead of five were spaced within it. An exterior hipped-roof vestibule containing the center entrance likely was added in the renovation. End walls also are irregular. The east end contains a single window centered on the first story, two windows widely-spaced on the second story and a single attic window centered in the gable. The west end has two windows on the first story, three on the second and one centered in the attic. What probably was a kitchen ell on the rear constructed about 1855 has become a hyphen connecting to a recent two-story addition of roughly equivalent size and design as the historic portion on the front. The principal entrance to the expanded house has been moved from the street façade, where there is no walkway to the entrance to the southeast side via an entrance in the hyphen. A porch is tucked into the second story of the hyphen above the entrance.

A small mid nineteenth-century domestic barn has been preserved behind the house. The story-and-a-half wood frame building has a front gable façade containing central wagon and mow doors. A shed roof wing on the southeast side may have originated as a stable. The house is centered on the street frontage set back behind an open lawn with paved driveways on either side, one leading to the barn and rear of the house and the other to the main entrance on the southeast side. The rear of the parcel is wooded.

HISTORICAL NARRATIVE

The deed history of the house at 193 Jewett Street is difficult to determine with certainty. It was probably built by 1798 by Abraham Brown, who in that year, according to the federal direct tax schedules, was renting the property to Rowley joiner Mark Cheney (1773-1850). In the same year, Brown sold the 7-acre tract with its buildings to Cheney.¹ He and his first wife Mary Pike, who he married in 1799, had three children—Samuel Pike in 1800, Luther in 1802, and Mary in 1804. Mary Cheney died in 1805, and in 1808 Cheney married Sarah Tenney and had three more children who lived into adulthood—Moody, born in 1809, Greenleaf (1810-55), and Henrietta Maria, born in 1813.

The 1830 map attaches the name “L. Cheney,” no doubt meaning to indicate son Luther, to the house. Luther Cheney, a shoemaker, is clearly shown in this house in the 1840 census, where he is enumerated between the households of his sister Mary, wife of Moses Wood Howe (1795-1879), and that of Samuel Jewett, who operated the town’s almshouse to the southeast. But by 1850 he and his family had moved to Ipswich. The 1850 census shows the widowed Mark Cheney with \$3200 in real property, though apparently not in this house, living with his unmarried daughter Henrietta and unmarried son Greenleaf, shown as a farmer though he was also a Congregationalist minister. Mark Cheney died in 1850, and in 1851 his children deeded 193 Jewett Street to their brother Greenleaf and the property just west of it to their sister Mary Cheney Howe (1804-94), the wife of Moses Wood Howe (1795-1879), who had been enumerated before the Cheney household in the 1840 census. Moses Wood Howe was the son of Reuben Howe (1755-1835), who had occupied a double house with his father Philemon Howe (1730-1819)

¹ Abraham Brown to Mark Cheney, 28 April 1798, SECD 163:146. No other deed is listed showing Mark Cheney as a grantee until 1808, when Cheney’s father Jonathan deeded him .33 acre and its buildings opposite his own house on the north side of the road from Byfield to Bradford; Jonathan Cheney to Mark Cheney, 8 March 1808, SECD 184:85.

INVENTORY FORM B CONTINUATION SHEET

GEORGETOWN

193 Jewett Street

MASSACHUSETTS HISTORICAL COMMISSION

Area(s) Form No.

GEO.234
GEO.235

220 MORRISSEY BOULEVARD, BOSTON, MASSACHUSETTS 02125

in 1815.² The 1850 census shows Moses and Mary Howe with their children Charles Edwin (born 1832) and Lucy May (born 1834) in the household with the elderly widow Molly Stickney. The house enumerated next to it was unoccupied, and the poorhouse enumeration followed it in this as in the 1840 census.

The 1855 census shows Moses and Mary Cheney Howe and their daughter Lucy in the same house with Mary's half-brother Greenleaf Cheney, who died that year at the age of 44. The 1856 map labels 193 Jewett "G. Cheney Est." By 1865 Moses and Mary Howe were sharing the 193 Jewett Street house with their daughter Lucy and her husband George H. Dole, who married in 1859, and the Doles' 3-year-old son Charles. By 1870 the two families are enumerated in separate but consecutive households, and the 1872 map of Georgetown shows both this house and the one west of it were both owned by Moses W. Howe. George H. Dole is shown in the 1870 census with only personal property, and by then he and his wife had had a third child, Lizzie, born in 1866.

Moses Howe died in 1879, and the 1880 census shows his widow alone in the house. She died in 1894, and the 193 Jewett Street house passed to George H. Dole, who had by then moved with his family to Haverhill; he worked as a bookkeeper and by 1900 as an undertaker in the firm Dole and Childs. His son Charles is shown in Georgetown in the 1900 census with his wife Luella and 2-year-old daughter Ina. In 1916 George H. Dole and his children deeded the property to his daughter Lizzie (variously shown as Ellen E., E. Elizabeth, and Lizzie Ellen) and Charles, in 1917 they subdivided the properties, and in 1925 Charles, Lizzie, and their brother Albert deeded the former Howe house to Lizzie and 193 Jewett to Charles.³ The 1918 and 1925 Georgetown directories show both George H. Dole and his son Charles as working in Haverhill but living on the south side of Jewett "beyond Tenney" Street, but they and Lizzie Dole were living at all other times in Haverhill, Lizzie in a house with her brother Albert and Charles, president of Haverhill's First National Bank by 1915, with his own family.

The 193 Jewett Street property remained in the Dole family until 1953, when Charles Dole's sons Howard N. and George E. sold it to William S. Phillips, whose family owned it until 1985. Current owners Albert J. and Alicia-Fe Belisle bought the property in 1987.⁴

BIBLIOGRAPHY and/or REFERENCES

AmericanAncestors.org.

Ancestry.com.

Assessor's Records, Georgetown and Rowley. 1883, 1902, 1920, 1933.

Bureau of the Census. United States Census, 1790-1930.

Lainhart, Ann S. "1855 and 1865 Massachusetts State Censuses for Georgetown." Boston: Ann S. Lainhart, 1987.

² No deed showing Philemon Howe as a grantee has been located, but in 1785 Moses Chaplin Jr. deeded to Reuben Howe 1.5 acres bordering land owned by Philemon Howe on "Hunsley Hill," in Rowley, now in Ipswich, and in 1815 Reuben Howe sold Lydia Bailey west half of a house he was then living in with his father, who occupied the east end. Two months later Bailey sold this and two other parcels to Reuben Howe's wife Elizabeth Howe. See Moses Chaplin Jr. and Elizabeth Chaplin to Reuben Howe, 6 April 1785, SECD 143:182; Reuben Howe to Lydia Bailey, 14 June 1816, SECD 211:46; Lydia Bailey to Elizabeth Howe, 22 August 1816, SECD 211:46. On the Howe family see M. V. B. Perley, "Abraham Howe and Some of His Descendants," *Essex Institute Historical Collections* 56, 1 (January 1920): 50-69.

³ George H. Dole, Ellen E. Dole, and Albert W. Dole, Haverhill, to Charles E. Dole, Haverhill, 6 November 1916, NBCD 2741:449; George H. and Albert W. Dole and Charles E. Dole, all Haverhill, to Ellen E. Dole, Haverhill, 6 November 1916, SECD 2741:448; George H. and Albert W. Dole and Charles E. Dole, all Haverhill, to Ellen E. Dole, Haverhill, 6 November 1916, SECD 2741:448; Charles E. Dole and Albert W. Dole, Haverhill, to Lizzie Ellen Dole, Haverhill, 18 June 1925, SECD 2741:450. This last deed cites the subdivision plan "Property of Geo. H. et al & Chas. E Dole, Located in Georgetown, Mass.," January 1917, which does not appear to have been recorded.

⁴ Howard N. Dole, Haverhill, and George E. Dole, Farmington NH, to William S. Phillips, 31 July 1953, SECD 4000:123; Richard S. Phillips, trustee Phillips Realty Trust, to Darlene A. Lynch and James F. Lynch III, 193 Jewett, 12 July 1985, SECD 7829:82; Richard W. Desmond and David Carnevale, Beverly, to Albert J. and Alicia-Fe Belisle, Jewett Street, 15 May 1987, NBCD 8965:499. The 193 Jewett Street property is Lot C on "Plan of Land in Georgetown, MA," 27 February 1987, SECP 225:48.

INVENTORY FORM B CONTINUATION SHEET

GEORGETOWN

193 Jewett Street

MASSACHUSETTS HISTORICAL COMMISSION

Area(s) Form No.

GEO.234
GEO.235

220 MORRISSEY BOULEVARD, BOSTON, MASSACHUSETTS 02125

Nelson, Henry M. "Town of Georgetown History." In Hurd, D. Hamilton. *History of Essex County, Massachusetts, with Biographical Sketches of Many of Its Pioneers and Prominent Men*. Vol. 1. Philadelphia: J. W. Lewis and Co., 1888.

Perley, M.V.B. "Abraham Howe and Some of His Descendants," *Essex Institute Historical Collections* 56:1 (Jan. 1920): 50-69.

Southern Essex County Registry of Deeds website, salemdeeds.com.

DIRECTORIES

The Essex County Directory. 1866. Boston: Innes & Niles, 1866.

Essex County History and Directory. Boston: C. A. & J. F. Wood, 1870.

Resident and Business Directory of Groveland and Georgetown, Mass., for 1885-1886. Needham, MA: Local Directory Publishing Co., 1885.

Georgetown, Boxford, Byfield, Newbury, and West Newbury, Massachusetts, Directory. Boston: W. E. Shaw, 1901-2, 1905.

North Essex Directory for Boxford, Georgetown, Merrimac, Newbury, Rowley, Salisbury, West Newbury. Salem, MA: Henry M. Meek Publishing Co., 1907, 1909-10, 1912, 1914-15, 1916-17, 1918, 1925.

Ipswich, Boxford, Byfield, Georgetown, Newbury, Rowley, Salisbury, Salisbury Beach, Topsfield, West Newbury Directory. Vol. 1, 1932-'34. Beverly, MA, and Portland, ME: Crowley & Lunt, 1932.

Haverhill, Mass. Suburban Directory for Georgetown, Groveland, Merrimac and West Newbury 1940. North Hampton, NH: Crosby Publishing Co., 1940.

Ipswich, Boxford, Georgetown, Middleton, Newbury, Rowley, Salisbury, Topsfield, West Newbury Directory 1957. New Haven, CT: Price & Lee Co., 1957.

MAPS

"Map of the Centre of Georgetown in 1800." In Perley, Sidney H., "Centre of Georgetown in the Year 1800." *The Essex Antiquarian: A Quarterly Magazine Devoted to the Biography, Genealogy, History, and Antiquities of Essex County, Massachusetts* 2, 7 (July 1898): 201.

Map of Georgetown in 1810 and 1840. In Gage, Thomas. *The History of Rowley, Anciently Including Bradford, Boxford, and Georgetown, from the Year 1639 to the Present Time*. Boston: F. Andrews, 1840. 320.

"Map of New Rowley Surveyed and Drawn by Philander Anderson 1830." Georgetown Historical Society.

Map of Georgetown. 1856. In Walling, H. F. *A Topographical Map Essex County Massachusetts*. Boston: Smith and Morley, 1856.

Atlas of Essex County, Massachusetts. Philadelphia: D. G. Beers and Co., 1872). Plates 59 and 61.

"Town of Georgetown Mass." and "Village of Georgetown Mass." In *Atlas of Essex County, Massachusetts* (Boston: George H. Walker, 1884).

"Georgetown, Mass. 1887." Drawn and Published by George E. Norris, Brockton, Massachusetts. Troy, NY: Burleigh Lithographic Establishment, 1887."

Insurance Maps of Haverhill Including Bradford, Groveland & Georgetown, Massachusetts. New York: Sanborn-Perris Map Co., 1893; Sanborn Map Co., 1906, 1949.

INVENTORY FORM B CONTINUATION SHEET

GEORGETOWN

193 Jewett Street

MASSACHUSETTS HISTORICAL COMMISSION

Area(s) Form No.

GEO.234 GEO.235

220 MORRISSEY BOULEVARD, BOSTON, MASSACHUSETTS 02125

PHOTOGRAPHS (all photos by Neil Larson, 2017)



View from east.

INVENTORY FORM B CONTINUATION SHEET

GEORGETOWN

193 Jewett Street

MASSACHUSETTS HISTORICAL COMMISSION

Area(s) Form No.

GEO.234 GEO.235

220 MORRISSEY BOULEVARD, BOSTON, MASSACHUSETTS 02125



View from NE.