

INVENTORY FORM B CONTINUATION SHEET

GEORGETOWN

182 Pond Street

MASSACHUSETTS HISTORICAL COMMISSION

Area(s) Form No.

GEO.297

220 MORRISSEY BOULEVARD, BOSTON, MASSACHUSETTS 02125

FORM B – BUILDING

MASSACHUSETTS HISTORICAL COMMISSION
MASSACHUSETTS ARCHIVES BUILDING
220 MORRISSEY BOULEVARD
BOSTON, MASSACHUSETTS 02125

Photograph

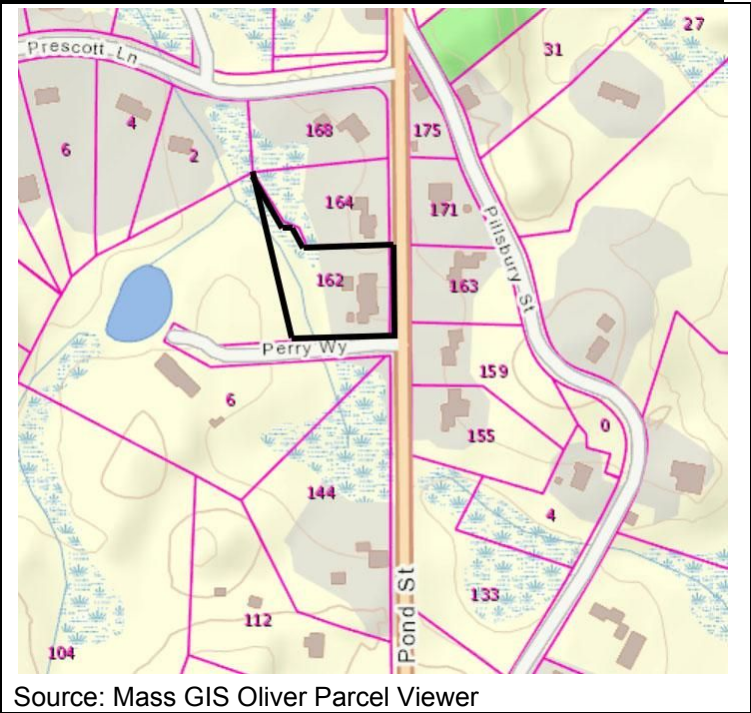

Recorded by: Kathryn Grover & Neil Larson
Organization: Town of Georgetown Historical Commission
Date: June 2017

Locus Map (north at top)

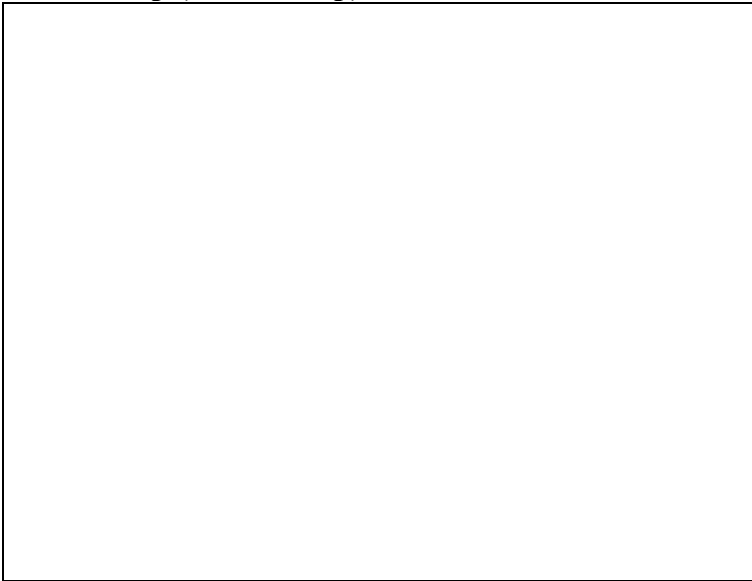

INVENTORY FORM B CONTINUATION SHEET

GEORGETOWN

182 Pond Street

MASSACHUSETTS HISTORICAL COMMISSION

Area(s) Form No.

GEO.297

220 MORRISSEY BOULEVARD, BOSTON, MASSACHUSETTS 02125

Assessor's Number USGS Quad Area(s) Form Number

12-2A

Georgetown

GEO.297

Setting: Rural road with historic farmhouses and in-fill residential development.

Town/City: Georgetown

Place: (*neighborhood or village*):
North Georgetown

Address: 182 Pond Street

Historic Name: Moses & Olive Harriman House

Uses: Present: single family residential

Original: single family residential

Date of Construction: ca. 1804

Source: deeds & visual assessment

Style/Form: Federal

Architect/Builder: unknown

Exterior Material:

Foundation: stone

Wall/Trim: vinyl clapboards

Roof: asphalt shingles

Outbuildings/Secondary Structures:

Garage (attached)

Major Alterations (*with dates*):

Garage & breezeway added, late 20th century

Sun porch added, mid-20th century

Vinyl siding added

Condition: fair

Moved: no ☒ yes ☐ **Date:**

Acreage: 2.06 acres

INVENTORY FORM B CONTINUATION SHEET

GEORGETOWN

182 Pond Street

MASSACHUSETTS HISTORICAL COMMISSION

Area(s) Form No.

GEO.297

220 MORRISSEY BOULEVARD, BOSTON, MASSACHUSETTS 02125

☐ Recommended for listing in the National Register of Historic Places.

If checked, you must attach a completed National Register Criteria Statement form.

ARCHITECTURAL DESCRIPTION:

The Moses and Olive Harriman House is a two-story wood frame single-family dwelling with a gable roof built about 1804. Its bilaterally symmetrical form and center-hall plan a room-and-a-half deep has a five-bay front façade with a center entrance embellished only with an added cornice. The second story contains five windows aligned with the openings below them. Corner and eave-line features have been obliterated or obscured by added siding. There are three windows per floor on the gable ends and single attic windows centered in the gables.

A wide two-story cross-gable wing extends from corner to corner across the rear of the house. The large wing was added about 1850, possibly replacing a much smaller annex, when the house was adapted to accommodate more than one family. The extension appears to have been divided down the ridge to provide kitchen and service areas for separate domiciles. Each had entrances on the side walls. The one extant on the south side is enclosed in an added sun porch, while the one on the north side now connects to a breezeway linking the house to a two-car garage.

The house is situated in the center of the road frontage set back behind a small yard. A driveway enters the parcel north of the house and runs up to the garage. Small yards occupy spaces on the sides and rear of the house; the rear of the parcel is wooded.

HISTORICAL NARRATIVE

In deeds dated in 1804 and 1805, Moses Harriman (1774-1849), the son of Moses Harriman Sr. (1737-84) and Jane Hale Harriman (1739-1825) of Bradford, acquired nine-tenths of a 100-acre farm in this north Georgetown neighborhood from his aunt and uncle (Moses and Margaret Harriman Burpee of Jaffrey, New Hampshire), his sisters Betsy (1784-1858) and Sarah Harriman Palmer (1765-1834), and a Newbury grantor of no known relation. A small "corner" of the farm lay in Bradford (now Groveland), and it had probably belonged to Moses's father Moses. The deeds included the west half of a house and the western two-thirds of a barn, as well as a "cyder house" and "chaise house" standing on the property. It is likely that the widow Jane Hale Harriman was meant to occupy the rest of the house. The 1798 federal direct tax lists for Rowley show her and her son Samuel (1769-1829) occupying a house owned by Moses Harriman's heirs.¹

The house cited in the deeds was the Bradford home of Moses Harriman Sr., while the 182 Pond Street house was built for Moses Harriman Jr. when he married Olive Brown of Boxford in Rowley in 1804. They had eight children between 1805 and 1819—Moses III, Samuel, Olive Jane, William Brown, Elizabeth, Charles A., Sophia Gage, and Maria. Harriman is listed in Rowley censuses from 1810 until he died in 1849, and 1830 and especially the 1840 censuses, both compiled in geographic rather than alphabetical order, clearly show Harriman on Pond Street. In his will, made scarcely a week before he died, Moses

¹ John and Sarah Palmer, Londonderry NH, Nathaniel Harriman, Bradford, and Samuel Harriman, Bradford, to Moses Harriman, Rowley, 24 February 1804, SECD 178:236; Paul Plumer, Newbury, to Moses Harriman, Rowley, 24 February 1804, SECD 178:235; Moses and Margaret Burpy, Jaffrey NH, Abigail Kezer, Rowley, to Moses Harriman, Rowley, 24 February 1804, SECD 178:236; Betsy Heriman, Bradford, to Moses Heriman, Rowley, 27 April 1805, SECD 178:236. In 1801, three years before his marriage, Moses Harriman began to buy shares of a 50-acre farm in this part of Rowley West Parish, part of which was then being rented to the Rev. Shubael Lovell, pastor of the First Baptist Church of Rowley. From three different grantors, Harriman acquired five-sixteenths of two-thirds of a dwelling house and five-sixteenths of a barn and shop and 50 acres of land. Comparing the identification of abutters in the deed to the 1800 map of Georgetown, this farm was probably part of the large tract owned by Samuel Harriman (1732-1803), which ranged along the southeast (and possibly northwest) side of North street to the land of Amos Pillsbury on the east. In the same year, four grantors then living in New London, New Hampshire, leased the west end of the house then occupied by Lovell to Harriman for 999 years, at 3 cents a year in rent. See Timothy Jackman, Bradford, to Moses Heriman, Rowley, 29 January 1801, SECD 168:221; Thomas Burpee, New London NH, to Moses Harriman, 2 February 1801, SECD 169:93; Daniel Cheney, Bradford, to Moses Harriman, Rowley, 4 March 1801, SECD 169:92; indenture between Ebenezer and Sally Shepard, Jeremiah Burpe, Henry and Patty Archiles, Joanna Burpee, all of New London NH, and Moses Harriman, 2 February 1801, SECD 169:93.

INVENTORY FORM B CONTINUATION SHEET

GEORGETOWN

182 Pond Street

MASSACHUSETTS HISTORICAL COMMISSION

Area(s) Form No.

GEO.297

220 MORRISSEY BOULEVARD, BOSTON, MASSACHUSETTS 02125

Harriman left his daughter Olive Jane \$300 "for services and work done by her family," one-sixth of his estate in trust to son Moses III, one-third of his estate to his widow Olive Brown Harriman, and the rest in equal shares to his children Samuel, Olive Jane, William B., Charles A., and Sophia G. Palmer. He owned at this death \$6741 in real estate, \$5569 of which was his 113-acre home farm with its house, barn, and outbuildings. In October 1849 Harriman's children and Moses Harriman III's trustee sold parts of the homestead, with half of their father's house and barn, and two other tracts to their sisters Olive Jane Harriman and Sophia Gage Harriman Palmer.²

In 1850 Olive Jane Harriman married Vermont-born farmer Jared Hyde in Georgetown, and the 1850 census appears to show the couple and her mother living in this house; son Moses was then living in Groveland in the family of his sister Sarah Harriman Palmer. Olive Brown Harriman died in 1851, and by 1860 Moses Harriman II was in listed in a four-family household enumerated just after the home of Jared and Olive Hyde. By 1865 the Hydys and Moses Harriman III occupied 182 Pond Street.

Jared and Olive Harriman Hyde owned and occupied 182 Pond Street until they died, she in 1884 and he in 1894. In 1898 Sophia G. Harriman Palmer sold her half of the property to Harvey M Hall, whose mother, Sarah J. Harriman Hall, acquired the other half from Olive J. Hyde through her will.³ Sarah Harriman Hall was Olive Hyde's niece, the daughter of her older brother Samuel Harriman and his wife Sally Palmer. The 1900 census shows Samuel and Sarah J. Hall in the household with their son F. Shirley, a shoemaker; married daughter Olive Augusta Brown and her husband Luther, a shoe factory edge setter, and their daughter Eleanor; in the other half of the house was son Harry M. Hall, a shoe factory finisher, his Canadian-born wife Nellie, and their children Marion Elizabeth and Olive Florence. The 1905 directory shows Sarah J. Hall as a widow living on the last house on Pond Street in Georgetown with Harry M. and Shirley also listed there.

In 1910 the children of Samuel and Sarah Hall sold 182 Pond Street to Manuel A. Perry of Peabody, who owned it for less than four years. In July 1915 it became the property of Michael Bonadio and Emanuele Germinara of Boston. Born in Platania, Italy, the men were farm workers, and they were living in this house in Georgetown from at least 1917 to 1925. Germinara and his family moved to Brook Street in Georgetown by 1930, while Bonadio and his family moved to West Newton. In 1927 they sold the property to Ralph S. and Lillias Grinnell Prescott, who owned it for the next 40 years.⁴

Born in Exeter, Penobscot County, Maine, in 1895, Ralph Sewell Prescott lived with his wife and family in his native place before moving to Pond Street; he worked as a fairgrounds caretaker. The couple had eight children—Melville G., S. Elizabeth, George S., Ruth L., Esther M., Mabel E., Ralph S. Jr., and Priscilla A.—between 1916 and 1930. Prescott is shown as a farmer in the 1940 and 1957 directories. In 1967 he and his wife sold 182 Pond Street to George I. and Nancy D. Thompson, the current owners.⁵

BIBLIOGRAPHY and/or REFERENCES

AmericanAncestors.org.

Ancestry.com.

Assessor's Records, Georgetown and Rowley. 1883, 1902, 1920, 1933.

Bureau of the Census. United States Census, 1790-1930.

² Samuel Harriman and Moody M. and Sophia G. Palmer, Bradford, and Theodore G. Elliot, trustee of Moses, Wm B and Chas A Harriman to Olive Jane Harriman, 10 October 1849, SECD 440:69; Samuel Harriman, Bradford, and Theodore G. Elliot, trustees of Moses Harriman, Olive Jane Harriman, William B. Harriman, and Charles A. Harriman, all Georgetown, to Sophia G. Palmer, 10 October 1849, SECD 443:152.

³ Sophia G. Palmer, Groveland, to Harvey M. Hall, 17 October 1898, SECD 1564:316. Olive Hyde's 23 April 1868 will left to her niece Sarah J. Hall, the wife of Samuel M. Hall, the use and improvement of all her Georgetown real property, and after her death in equal shares to Hall's children—Charles Hilliard, Harry M., and Olive Augusta Hall. She left pasture in Groveland to other nieces—Olive A. Adams and Addie M., Victoria A., and Mary S. Palmer—the children of her younger sister Sophia Gage Harriman and her husband, Moody Morse Palmer (siblings Sarah and Moody Morse Palmer married siglings Samuel and Sophia Gage Harriman).

⁴ Charles H. Hall, Harry M. Hall, Alice J. Smith (wife of James R.), Augustu O. Brown (wife of L. LeRoy Brown) and Shrlay F. Hall to Manuel A. Perry, Peabody, 23 September 1910, SECD 2047:6; Abbie F. Johnson to Michael Bonadio and Emanuele Germinara, Boston, 19 July 1915, SECD 2302:273; Michael Bonadio and Emanuele Germinara to Ralph S. and Lillias Grinnell Prescott, 20 June 1927, SECD 2725:114.

⁵ Ralph S. and Lillias G. Prescott to George I. and Nancy D. Thompson, 18 August 1967, SECD 5480:361.

INVENTORY FORM B CONTINUATION SHEET

GEORGETOWN

182 Pond Street

MASSACHUSETTS HISTORICAL COMMISSION

Area(s) Form No.

GEO.297

220 MORRISSEY BOULEVARD, BOSTON, MASSACHUSETTS 02125

Nelson, Henry M. "Town of Georgetown History." In Hurd, D. Hamilton. *History of Essex County, Massachusetts, with Biographical Sketches of Many of Its Pioneers and Prominent Men*. Vol. 1. Philadelphia: J. W. Lewis and Co., 1888. Southern Essex County Registry of Deeds website, salemdeeds.com.

DIRECTORIES

Georgetown, Boxford, Byfield, Newbury, and West Newbury, Massachusetts, Directory. Boston: W. E. Shaw, 1901-2, 1905.
North Essex Directory for Boxford, Georgetown, Merrimac, Newbury, Rowley, Salisbury, West Newbury. Salem, MA: Henry M. Meek Publishing Co., 1907, 1909-10, 1912, 1914-15, 1916-17, 1918, 1925.
Ipswich, Boxford, Byfield, Georgetown, Newbury, Rowley, Salisbury, Salisbury Beach, Topsfield, West Newbury Directory. Vol. 1, 1932-'34. Beverly, MA, and Portland, ME: Crowley & Lunt, 1932.
Haverhill, Mass. Suburban Directory for Georgetown, Groveland, Merrimac and West Newbury 1940. North Hampton, NH: Crosby Publishing Co., 1940.
Ipswich, Boxford, Georgetown, Middleton, Newbury, Rowley, Salisbury, Topsfield, West Newbury Directory 1957. New Haven, CT: Price & Lee Co., 1957.

MAPS

"Map of New Rowley Surveyed and Drawn by Philander Anderson 1830." Georgetown Historical Society.
Map of Georgetown. 1856. In Walling, H. F. *A Topographical Map Essex County Massachusetts*. Boston: Smith and Morley, 1856.
Atlas of Essex County, Massachusetts. Philadelphia: D. G. Beers and Co., 1872). Plates 59 and 61.
"Town of Georgetown Mass." and "Village of Georgetown Mass." In *Atlas of Essex County, Massachusetts* (Boston: George H. Walker, 1884).

PHOTOGRAPHS (all photos by Neil Larson, 2017)

INVENTORY FORM B CONTINUATION SHEET

GEORGETOWN

182 Pond Street

MASSACHUSETTS HISTORICAL COMMISSION

Area(s) Form No.

GEO.297

220 MORRISSEY BOULEVARD, BOSTON, MASSACHUSETTS 02125



View from SE.

INVENTORY FORM B CONTINUATION SHEET

GEORGETOWN

182 Pond Street

MASSACHUSETTS HISTORICAL COMMISSION

Area(s) Form No.

GEO.297

220 MORRISSEY BOULEVARD, BOSTON, MASSACHUSETTS 02125



View from north



INVENTORY FORM B CONTINUATION SHEET

GEORGETOWN

182 Pond Street

MASSACHUSETTS HISTORICAL COMMISSION

Area(s) Form No.

GEO.297

220 MORRISSEY BOULEVARD, BOSTON, MASSACHUSETTS 02125

Aerial view from west. Source: bing.com/maps.