

INVENTORY FORM B CONTINUATION SHEET

GEORGETOWN

129 Pond Street

MASSACHUSETTS HISTORICAL COMMISSION

Area(s) Form No.

GEO.295

220 MORRISSEY BOULEVARD, BOSTON, MASSACHUSETTS 02125

FORM B – BUILDING

MASSACHUSETTS HISTORICAL COMMISSION

MASSACHUSETTS ARCHIVES BUILDING

220 MORRISSEY BOULEVARD

BOSTON, MASSACHUSETTS 02125

Photograph



View from south.

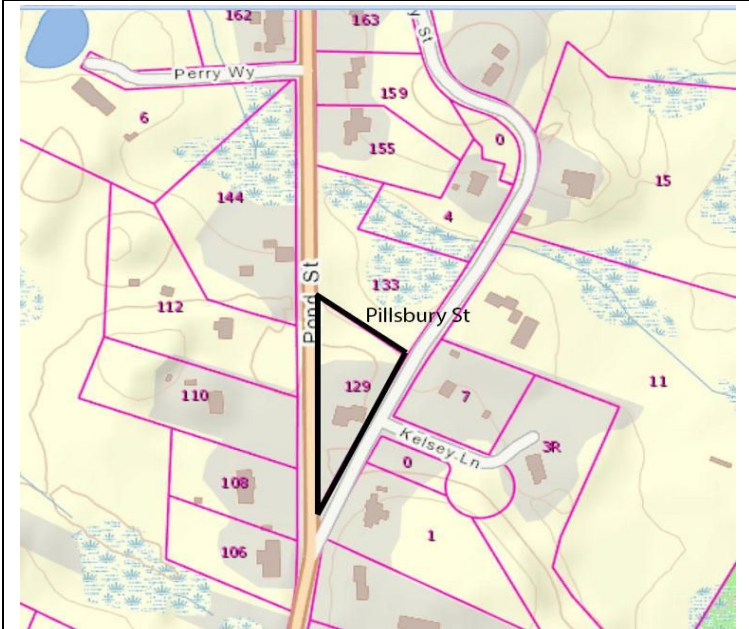

Source: Mass GIS Oliver Parcel Viewer

Recorded by: Kathryn Grover & Neil Larson

Organization: Town of Georgetown Historical Commission

Date: June 2017

Locus Map (north at top)

INVENTORY FORM B CONTINUATION SHEET

GEORGETOWN

129 Pond Street

MASSACHUSETTS HISTORICAL COMMISSION

Area(s) Form No.

GEO.295

220 MORRISSEY BOULEVARD, BOSTON, MASSACHUSETTS 02125

Assessor's Number USGS Quad Area(s) Form Number

12-36

Georgetown

GEO.295

Setting: Rural road with historic farmhouses and in-fill residential development.

Town/City: Georgetown

Place: (*neighborhood or village*):
Pentucket Pond

Address: 129 Pond Street

Historic Name: Pillsbury-Graf-Puopolo House

Uses: Present: single family residential

Original: single family residential

Date of Construction: ca. 1850

Source: deeds & visual assessment

Style/Form: Classical Revival

Architect/Builder: unknown

Exterior Material:

Foundation: stone

Wall/Trim: wood clapboards

Roof: asphalt shingles

Outbuildings/Secondary Structures:
None

Major Alterations (*with dates*):

Additions on side and rear, late 20th century

Doors, windows & siding replaced, late 20th century

Condition: fair

Moved: no ☒ yes ☐ **Date:**

Acreage: 0.92 acre

INVENTORY FORM B CONTINUATION SHEET

GEORGETOWN

129 Pond Street

MASSACHUSETTS HISTORICAL COMMISSION

Area(s) Form No.

GEO.295

220 MORRISSEY BOULEVARD, BOSTON, MASSACHUSETTS 02125

☐ Recommended for listing in the National Register of Historic Places.

If checked, you must attach a completed National Register Criteria Statement form.

ARCHITECTURAL DESCRIPTION:

The Pillsbury-Graf-Puopolo House is a two-story wood frame single-family dwelling with a gable roof built about 1850. Its bilaterally symmetrical form and double-pile center-hall plan has a three-bay front façade with a center entrance containing a replaced doorway and pedimented architrave. The second story contains only two windows aligned with those below them; the space above the center entrance is windowless. Windows appear to be entirely replaced indicating that the clapboard also is not original. A brick chimney is oddly located in the center of the front section of the roof. The west gable end contains two windows on each floor including the attic; these windows also replaced with the possible exception of the attic pair, which are capped with cornices. An addition on the rear of the house is covered by a saltbox extension of the rear roof; the entire roof has been covered with raised-seam metal. The one-story rear wall of this addition contains sliding glass doors opening on a deck; three skylights are evenly spaced across the roof. Fenestration on the east gable end has been altered, to which a two-story gable roof wing has been added. The site was excavated to provide access to two garage bays at grade sheltered by a pent roof. An entrance is located in the upper story accessed by exterior stairs leading up from the driveway. The wing's east gable end contains two windows on each floor, the rear wall contains a door at garage level and two windows and a sliding glass door opening on a deck on the upper level.

The house is situated in the acute angle of the intersection of Pond Street and Pillsbury Road with a deep, pointed yard in front and a large yard in the rear; the northern section of the lot is wooded. A driveway enters the property from Pillsbury Road and terminates at the garages in the added wing.

HISTORICAL NARRATIVE

Deeds transferring 129 Pond Street from 1899 forward refer to the property as having been inherited by Aaron Nelson Pillsbury (1820-96) from his father Amos Pillsbury, who died in 1858 in Georgetown at his homestead just north of here on Pillsbury Road. No deed has been found conveying the property from father to son, Amos Pillsbury apparently left no will, and his real estate inventory does not record more than one lot with buildings on it. However, the order of the 1850 census enumeration seems to make clear that Aaron Pillsbury was living at 129 Pond Street by then and owned it: the census put the property's value at \$1200. Though no marriage record has yet been located for him, he had married Elizabeth Ann Goodale of Boxford by then. The couple had no children, then or later. Only Amos Pillsbury's house is shown on the 1830 Georgetown map, but the 1856 map shows Aaron's house, at the north side of the intersection of Pond Street and Pillsbury Road, and his father's homestead to the north between Pond Street and Pillsbury Road. In between the two, on the east side of Pillsbury Road, was the home of Aaron's married sister Eliza Pillsbury Brown and her husband Edwin.

Aaron Pillsbury was a shoemaker, and in 1855 he and his wife Eliza (born Lisa Mary) had the income of boarders Charlotte Hall and her daughter Martha. After Amos Pillsbury's death in 1858, his real estate was valued at \$2935 and was composed of 106 acres in 12 parcels. The administrator of his estate sold seven of them to cover his debts. His widow paid \$760.96 for unidentified land, the about 4-acre homestead property and other parcels, while "Lissa Mary Pillsbury" paid \$61.79, perhaps for the farm she and her husband occupied but may not technically have owned.

In 1860 Aaron and Eliza Pillsbury shared 129 Pond Street with Baptist clergyman Joseph H. Seaver and shoemaker Andrew George and his wife. The agricultural census for that year shows Pillsbury with 24 acres and a modest output of peas, potatoes, and hay; he had two dairy cows and produced 200 pounds of butter. By 1877 the Pillsburys had moved to Groveland, where the 1880 census shows them boarding 15-year-old farm worker Charles E. Dole and Abbie Goodale, a 38-year-old woman probably

INVENTORY FORM B CONTINUATION SHEET

GEORGETOWN

129 Pond Street

MASSACHUSETTS HISTORICAL COMMISSION

Area(s) Form No.

GEO.295

220 MORRISSEY BOULEVARD, BOSTON, MASSACHUSETTS 02125

related to Eliza Pillsbury who is shown as having spinal problems, but they continued to own 129 Pond Street. Aaron Pillsbury died in Groveland in 1896, and in September 1899 his widow sold the Georgetown property to Anton Graf (or Graff) for \$1000.¹

Graf, born in Hungary in 1833, was shown in this neighborhood without occupation in a house with his Austrian-born wife Mary and their seven children. The eldest, Charles, was born in New Jersey in 1880, the second, Antonia, in New York in 1884, and the five other children in Massachusetts between 1888 and 1895. Graf was living in Georgetown by 1889, when he received a patent for "packing for safes," and he had other patents for an improved fire box for steam generators and a furnace door with improved insulation. In 1889 the *Haverhill Daily Evening Bulletin* noted that Graf "has agreed to light the Pentucket House with a new kind of gas which he claims to have discovered. He has already applied for patents upon the apparatus. He claims that one jet produces more illuminating power than an incandescent light, and the cost of producing the light a very small factor. The objection is its heat, which is intense. The building will soon be piped for the experiment."²

The 1901 directory shows Graf as an inventor living on Pond Street, but by the time he moved to Newbury around 1906 he was described as a mining expert and engineer. The 129 Pond Street house changed hands twice by March 1907, when T. Pratt Howard of Haverhill bought it.³ Born in 1861 in New York State, Howard was a landscape gardener in Haverhill and North Hampton, New Hampshire, through about 1910 and probably never lived at 129 Pond Street. In October 1929 John W. Hogan acquired it, and four years later he sold it to Henry M. Bearse of Cambridge, who worked as an assistant in charge of the Bureau of Fisheries at the Boston Fish Pier in 1938 and was a biologist and fishery marketing specialist for the U.S. Fish and Wildlife Service in the 1940s. The 1940 Georgetown directory, however, shows him as a poultry farmer living on Pond Street. In 1942 he sold 129 Pond Street to Robert W. Gordon, who owned it for less than three years. Current owners Francis A. and Patricia M. Puopolo acquired the property in 1985.⁴

BIBLIOGRAPHY and/or REFERENCES

AmericanAncestors.org.

Ancestry.com.

Assessor's Records, Georgetown and Rowley. 1883, 1902, 1920, 1933.

Bureau of the Census. United States Census, 1790-1930.

Nelson, Henry M. "Town of Georgetown History." In Hurd, D. Hamilton. *History of Essex County, Massachusetts, with Biographical Sketches of Many of Its Pioneers and Prominent Men*. Vol. 1. Philadelphia: J. W. Lewis and Co., 1888.

Southern Essex County Registry of Deeds website, salemdeeds.com.

DIRECTORIES*Georgetown, Boxford, Byfield, Newbury, and West Newbury, Massachusetts, Directory*. Boston: W. E. Shaw, 1901-2, 1905.

North Essex Directory for Boxford, Georgetown, Merrimac, Newbury, Rowley, Salisbury, West Newbury. Salem, MA: Henry M. Meek Publishing Co., 1907, 1909-10, 1912, 1914-15, 1916-17, 1918, 1925.

Ipswich, Boxford, Byfield, Georgetown, Newbury, Rowley, Salisbury, Salisbury Beach, Topsfield, West Newbury Directory. Vol. 1, 1932-'34. Beverly, MA, and Portland, ME: Crowley & Lunt, 1932.*Haverhill, Mass. Suburban Directory for Georgetown, Groveland, Merrimac and West Newbury 1940*. North Hampton, NH: Crosby Publishing Co., 1940.

¹ Elizabeth A. Pillsbury, Groveland, to Anton Graff, 19 September 1899, SECD 1588:351. On 19 May 1877 the children of Amos Pillsbury—Aaron, William B., and Elizabeth Brown—transferred parts of their father's real estate among each other, but none of the parcels conveyed included 129 Pond Street. See William B. Pillsbury and Elizabeth Brown to Aaron N. Pillsbury, 19 May 1877, SECD 976:97; Aaron N. Pillsbury, Groveland, William B. Pillsbury, Georgetown, to Elizabeth Brown, 19 May 1877, SECD 976:95; Aaron N. Pillsbury and Elizabeth Brown to William B. Pillsbury, 19 May 1877, SECD 976:97.

² "Georgetown," *Daily Evening Bulletin*, 21 September 1889, 3.

³ Anton and Mary Graf to Orinda A. Hall, 14 March 1905, SECD 1771:317; Orinda A. Hall to Israel Dlegech, Lynn, 13 June 1906, SECD 1829:547; Israel Dlegech to T. Pratt Howard, Haverhill, 6 March 1907, SECD 1910:497.

⁴ Ruth D. Gilliland, Lynn, to John W. Hogan, 17 October 1929, SECD 2826:246; John W. Hogan to Henry M. Bearse, Cambridge, 14 April 1933, SECD 2948:169; Henry M. Bearse to Robert W. Gordon, 12 September 1942, SECD 3312:234; Robert W. Gordon to James S. and Christine M. Boyland, Everett, 21 August 1945, SECD 3446:204; Christine M. Boyland to Francis A. and Patricia M. Puopolo, 129 Pond Street, 25 January 1985, SECD 7644:480.

INVENTORY FORM B CONTINUATION SHEET

GEORGETOWN

129 Pond Street

MASSACHUSETTS HISTORICAL COMMISSION

Area(s) Form No.

GEO.295

220 MORRISSEY BOULEVARD, BOSTON, MASSACHUSETTS 02125

Ipswich, Boxford, Georgetown, Middleton, Newbury, Rowley, Salisbury, Topsfield, West Newbury Directory 1957. New Haven, CT: Price & Lee Co., 1957.

MAPS

“Map of New Rowley Surveyed and Drawn by Philander Anderson 1830.” Georgetown Historical Society.
Map of Georgetown. 1856. In Walling. H. F. *A Topographical Map Essex County Massachusetts*. Boston: Smith and Morley, 1856.
Atlas of Essex County, Massachusetts. Philadelphia: D. G. Beers and Co., 1872). Plates 59 and 61.
“Town of Georgetown Mass.” and “Village of Georgetown Mass.” In *Atlas of Essex County, Massachusetts* (Boston: George H. Walker, 1884).

INVENTORY FORM B CONTINUATION SHEET

GEORGETOWN

129 Pond Street

MASSACHUSETTS HISTORICAL COMMISSION

Area(s) Form No.

GEO.295

220 MORRISSEY BOULEVARD, BOSTON, MASSACHUSETTS 02125

PHOTOGRAPHS (all photos by Neil Larson, 2017)



View from south.

INVENTORY FORM B CONTINUATION SHEET

GEORGETOWN

129 Pond Street

MASSACHUSETTS HISTORICAL COMMISSION

Area(s) Form No.

GEO.295

220 MORRISSEY BOULEVARD, BOSTON, MASSACHUSETTS 02125



View from SE.



View from NE.

INVENTORY FORM B CONTINUATION SHEET

GEORGETOWN

129 Pond Street

MASSACHUSETTS HISTORICAL COMMISSION

Area(s) Form No.

GEO.295

220 MORRISSEY BOULEVARD, BOSTON, MASSACHUSETTS 02125



View from NW.